



SPOTSYLVANIA CAPE

41'3" x 66'

2118 SQ. FT. (FINISHED) / 1295 SQ. FT. (UNFINISHED)

BEDROOMS: 3 BATHS: 2

SHOWN WITH OPTIONAL DOOR SIDELITES, FANLITE DOOR AND DORMERS

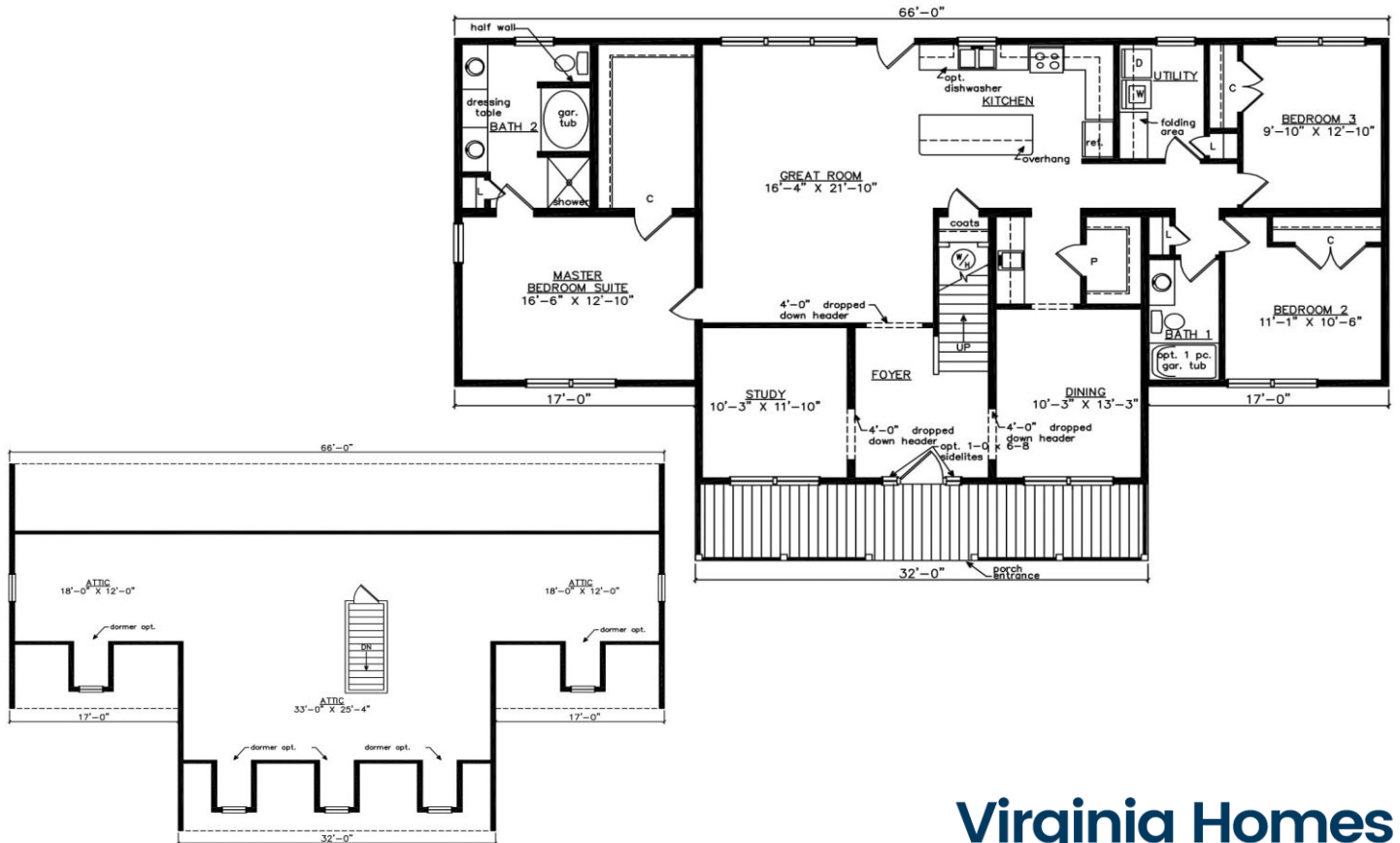

Virginia Homes
Building Systems

www.virginiahomesbuildingsystems.com

A Division of Modular Building Systems of PA